



STONHARD®

MANUFACTURER & INSTALLER OF SEAMLESS FLOOR SYSTEMS



More than 93 years.
Unprecedented leader in manufacturing
and installing seamless floors.

STONHARD



YOUR SPACE. OUR FLOORS.

STONHARD SOLVES FLOORING PROBLEMS. Punishing chemical assault, unremitting abrasion and impact, wet conditions, thermal shock — our proven performance systems are designed for the toughest environments. They are also designed with the planner in mind, offering infinite design possibilities and the ability to customize and optimize colours, patterns and finishes. Stonhard's seamless floor systems are textured for slip resistance. Maintenance is minimal, because seamless means cleaner. Stonhard takes full responsibility for customer satisfaction, from raw materials to installed systems. Over 300 Territory Managers, Architectural/Engineer and Design teams, and 200 application teams worldwide see that projects are completed on time and successfully meet all standards. Stonhard provides comprehensive support, whether it's a single location or part of a multi-national network.

Unparalleled products, easy maintenance, seamless, customized designs and our reliable single source warranty on it all.

| | | |
|------------------------|--|----|
| C O N T E N T S | Market Applications | 4 |
| | Installation | 6 |
| | Design | 8 |
| | Commitment to Sustainability | 9 |
| | Stonclad | 10 |
| | Stonshield | 12 |
| | Stonblend | 14 |
| | Stonres | 16 |
| | Stontec | 18 |
| | Stonlux | 20 |
| | Stongard | 22 |
| | Engineering Details | 24 |
| | Stonpath / Stondeck | 25 |
| | More Options & Solutions | 26 |



MARKET APPLICATIONS

WE BRING YOU MORE FLOORS FOR MORE MARKETS

It's not just about offering a product; it's about delivering a solution, and we've been delivering flooring solutions for more than 93 years.

Chemical Resistant. Stain Resistant. Static Control. Recycled Elements. Slip Resistant. Stand up to Thermal Shock & Cycling. Impact & Abrasion Resistant. Easy to Clean. Resilient. Sound Reducing. Low VOCs. Infection Control.

We will help you find the right floor for your environment. Our sales force will work with you, one-on-one, to find the ideal floor solution. We also offer the expertise of our Architectural/Engineer and Design Teams and Construction Management Group. Our application teams will install your products, adhering to regulations and details, while honouring your work schedule.

STONHARD

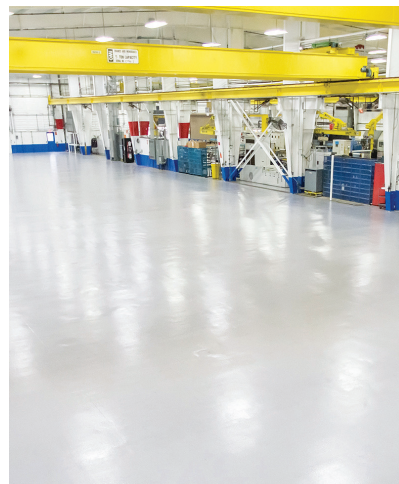

TRAFFIC AISLES | AIRPORT CONCOURSES | PROCESSING AREAS | CAFETERIAS | CONTROL ROOMS | PACKAGING LINES
CLASSROOMS | ASSEMBLY AREAS | CORRIDORS | MACHINE AREAS | LOBBIES

YOU'LL FIND OUR FLOORS WHEREVER THERE ARE INDUSTRIAL AND COMMERCIAL ENVIRONMENTS.
HERE ARE SOME OF THE CORE MARKETS WE SERVE:



Aerospace / Automotive – assembly lines, battery rooms, control rooms, hangars, plating lines, loading docks, mechanical rooms, test areas/labs, clean rooms.



Chemical, Petro Chemical & Mining – processing, containment, tank farms, bulk storage, drum storage, refineries, clarifiers, trenches, sumps.



Education – Universities, Schools, Vocational & Technical schools – classrooms, cafeterias, labs, libraries, multipurpose rooms, medical centres, stadiums, kitchens, vivariums, student centres.



Electronics / Technology – assembly, data centres, fan decks, clean rooms, waffle slabs, plating lines, inspection labs.



Food & Beverage – bakeries, bottling lines, dairies, kitchens, coolers, mixing, meat packing, processing, packing.



Healthcare – operating theatres, patient rooms, corridors, A+E, labs, kitchens, laundry, mechanical rooms, nurses stations, drop-off areas, parking.



Hospitality – lobbies, restaurants, kitchens, bars, fitness centres, casinos, nightclubs, pools, parking garages.



Pharmaceutical / Biotech – production, chemical storage, packing, labs, tableting, vivariums, washdown areas.



Retail – supermarkets, department stores, malls, car dealerships, parking garages.



Sports & Entertainment – stadiums, theme parks, arenas, zoos, museums, restaurants, concourses, concessions, retail, locker rooms, parking.



Transportation – Airports, Train Stations, Bus Terminals – concourses, maintenance facilities, baggage handling, hangars, waiting areas, kitchens & food service, restrooms, battery rooms, control rooms, service bays, train platforms, parking garages.



Water / Waste Water & Utilities – digesters, clarifiers, potable water contact, tank farms, unloading areas.



INSTALLATION

WE ARE RESPONSIBLE FOR YOUR INSTALLATION TOO

Expect performance from start to finish. From design specifications, to project management, to the final walk through, Stonhard works with you to ensure complete satisfaction on every project. This means you always work with us directly and not with agents or distributors.

STONHARD



STONHARD single source

A **turnkey approach** means you'll receive high quality products and installations consistently. From people to products and services, quality and dependability are a constant with Stonhard.

The **single source warranty** is Stonhard's pledge of responsibility. Our Territory Managers and Field Engineers are dedicated to your satisfaction. Site supervision and service are standard across the country and around the world.

Each Stonhard project receives attention on every level — multi-phase or small projects. Our Territory Managers, along with our Construction Management group, made up of 40 Project Managers, Site Superintendents and 200 application teams are your single source partners, assuring quality control, and integrated and flexible scheduling.

Stonhard offers the following technical literature:

- | | |
|------------------------------|-------------------------|
| Product Data Sheets | Cleaning Procedures |
| Product Guide Specifications | Colour Selection Guides |
| Chemical Resistance Guides | Product Samples |
| Safety Data Sheets | References |
| Case Histories | |



COLOUR. SCALE. BALANCE. TEXTURE. FINISH. FORM.

Our floors are engineered for specific applications. From bustling, unrelenting process areas and kitchens, to soothing, healing environments; we manufacture and install seamless floors that meet your performance expectations and your design touchstones. In addition to a wide array of standard colours, we offer exclusive colour palettes, tailored blends and customized logos. Our Territory Managers, along with our Architectural/Engineer and Design teams, will work with you to help with product selection.

You will find colour selections in the product pages of this brochure, however not all standard colours are shown. For additional standard colour collections visit our website, stonhard.co.uk or contact us for colour sheets or samples. Custom colour matching is available with sufficient lead time and minimum order requirements.

STONHARD

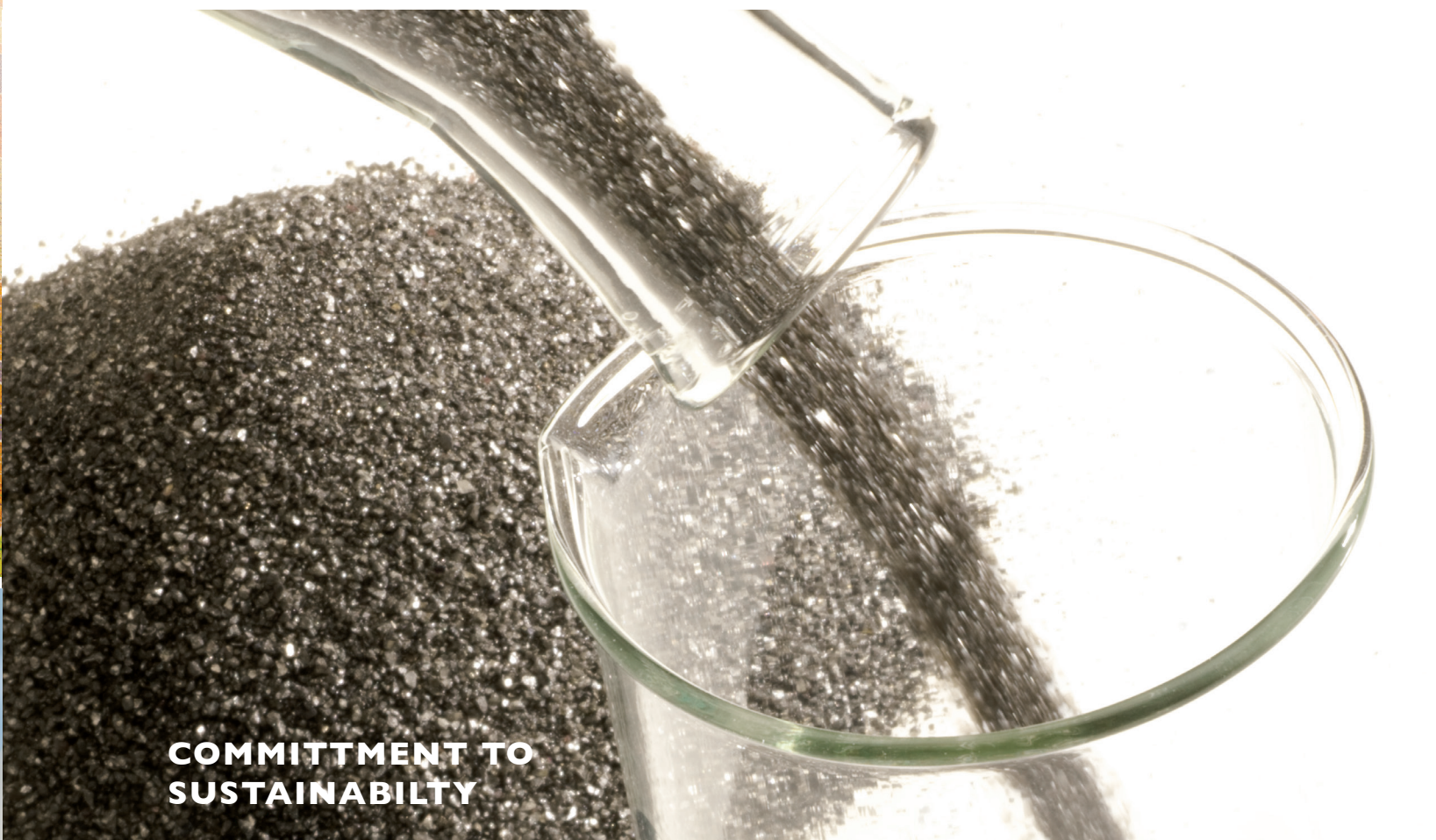
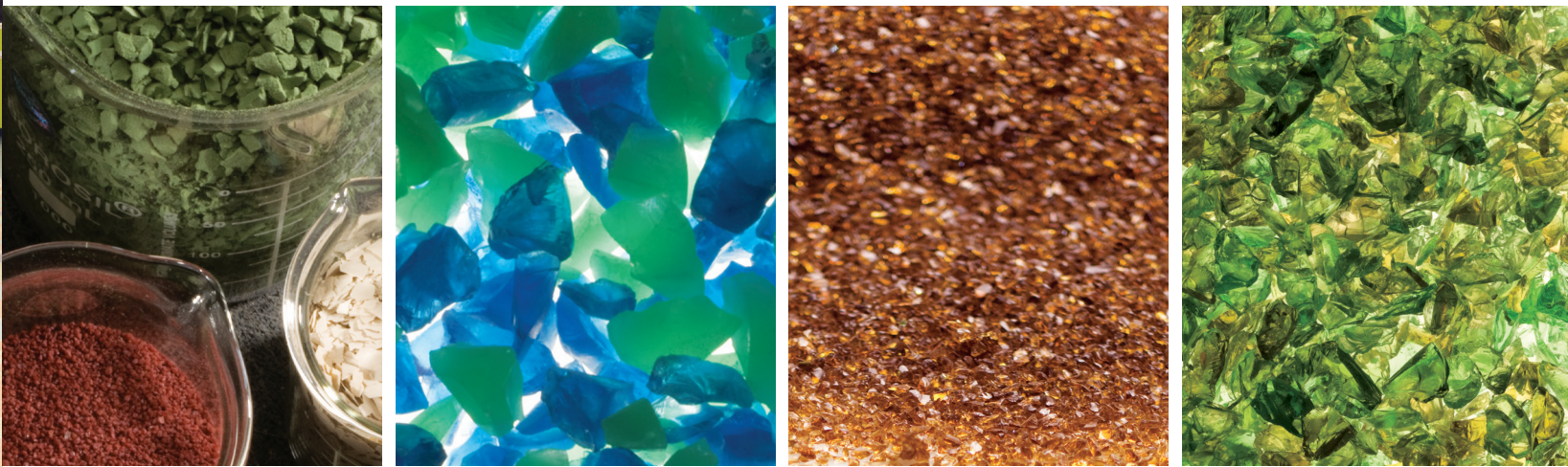

COMMITMENT TO SUSTAINABILITY

IT'S OUR NATURE TO BE SUSTAINABLE

The very makeup of our seamless, poured-in-place floors is sustainable. Our floors are bonded to a building's structure, so when a Stonhard floor reaches the end of its long life, it does not end up in a landfill. It can be replaced or restored without removing the floor. And that is only part of the story.

- Our products are low emission formulated.
- VOC content complies with existing EU regulations.
- We use innovative, flexible packaging that prevents millions of pails and cans from ever entering the waste stream.
- We produce 100% solids epoxy, water-based urethanes and rapidly renewable agro-based materials.
- Our seamless floors have no-wax finishes and are easy to clean. This saves on water and the use of harsh chemicals.



Indicates recycled glass in formulation. Ask your Stonhard representative about Stonhard's commitment to a healthier planet.



STONCLAD

Serious protection for heavy duty environments. Stonclad provides extraordinary performance under the most demanding conditions. Chemical, abrasion and impact resistant systems assure durability and longevity. Specialized configurations meet the needs of static control and temperature dependent environments. Diversity and performance for the most rigorous industrial applications.

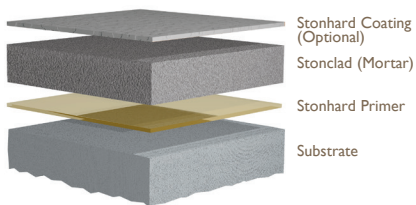

ESD|GS|GR|G2|HT|UR|UL

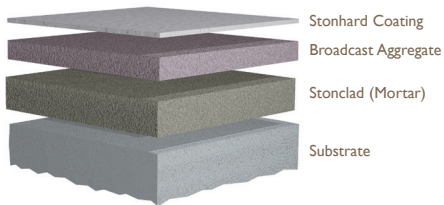

UT



STONCLAD® GS

Trowelled epoxy mortar system providing superior impact and abrasion resistance with excellent chemical resistance.

STONCLAD® GR

Trowelled epoxy mortar system with the same properties as Stonclad GS. This system utilizes 25% recycled glass fillers and a rapidly renewable component to enhance the material and make an environmental impact.

STONCLAD® G2

Sustainable, polyurethane mortar system that utilizes recycled glass and plant based resins. Formulated for food environments to withstand thermal shock and cycling.

STONCLAD® ESD

Conductive elements formulated in an epoxy resin for static control and non-sparking properties.

STONCLAD® HT

Ultra-corrosion resistant epoxy mortar system formulated to withstand temperatures up to 200°F/93°C (250°F/121°C for intermittent spills).

STONCLAD® UL

Self levelling, polyurethane mortar system that is chemical, impact and abrasion resistant, designed for dry food environments.

STONCLAD® UR

Trowelled polyurethane mortar system designed for rapid installation in food environments, where thermal cycling/thermal shock conditions are present and texture is not a requirement.

STONCLAD® UT

Trowelled polyurethane textured mortar system designed to withstand thermal shock/thermal cycling conditions for use in food environments.



STONSHIELD

Safe, easy to clean, with aesthetic appeal and design flexibility. The superior performance of Stonshield systems, along with ultra-slip resistant surfaces, ensure protection from slips and falls. These colour quartz broadcast systems are a cost-effective option for light manufacturing areas. Discover the unlimited design capabilities available in various textures, patterns and colours.

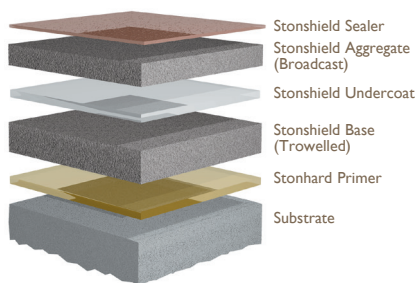

HRI|URI

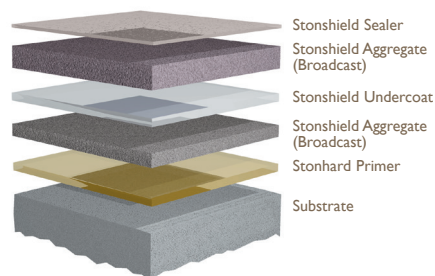

SLT|XPRESS|URT|ESD

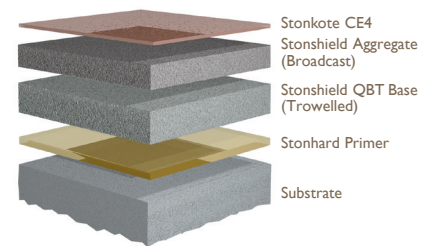

QBT

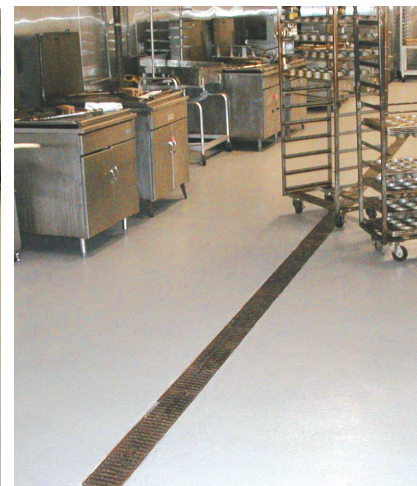

STONSHIELD® HRI

Trowelled epoxy mortar-based, textured, slip resistant system that is long-lasting, stylized and easy to clean. Perfect for food service and preparation, and light manufacturing. For education and healthcare environments, retail, sports and entertainment venues.

STONSHIELD® SLT

Cost-effective, textured, epoxy mortar system for light traffic areas. Offers reduced resistance to heavy impact and loads. For education and healthcare environments, retail, sports and entertainment venues.

STONSHIELD® Xpress

Methyl methacrylate resin-based system providing excellent chemical and wear resistance, moderate slip resistance and rapid installation time. For education and healthcare environments, retail, sports and entertainment venues.

STONSHIELD® URI

Trowelled polyurethane mortar textured system designed for food preparation and service areas where thermal shock and cycling are present.

STONSHIELD® URT

Textured polyurethane, cost effective system that can be installed quickly and with minimal odour.

STONSHIELD® ESD

Textured, conductive floor, offering superior static control properties. Ideal for use in AGV and traffic aisles, electronic parts assembly, when ESD-sensitive components are present.

STONSHIELD® QBT

Trowelled, epoxy mortar-based textured, slip resistant, easy to clean system, designed for multiple smaller areas when a quick installation is necessary; two day install. Ideal for education, healthcare and retail environments.



STONBLEND

A workhorse for demanding environments, yet meets savvy design standards for today's planners. Smart, smooth, stain and wear resistant floor system, Stonblend, a trowelled, colour quartz system is offered in sophisticated patterns and colour blends for a broad range of settings, including an exclusive formulation that utilizes recycled glass.

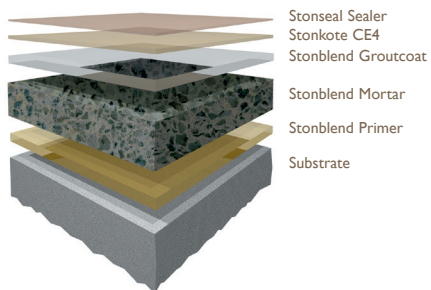

GSI | GSI - G | H D F

STONHARD



STONBLEND® GSI

Striking appearance and cost-effective alternative to terrazzo. Perfect flooring solution for pharmaceutical and healthcare facilities, animal laboratories, packaging areas, plant offices, public areas and R&D facilities.

STONBLEND® GSI-G

Stain and wear resistant epoxy mortar system that utilizes recycled glass aggregate in the surface of the system, creating a modern appearance, while remaining environmentally responsible. Performs in office and healthcare environments, educational and correctional institutions, pharmaceutical, packaging and R&D facilities.

STONBLEND® HDF

Decorative epoxy mortar system that exhibits increased physical properties, making it ideal for heavy duty pharmaceutical processing environments and animal laboratories.

— GSI / HDF —

— GSI-G —

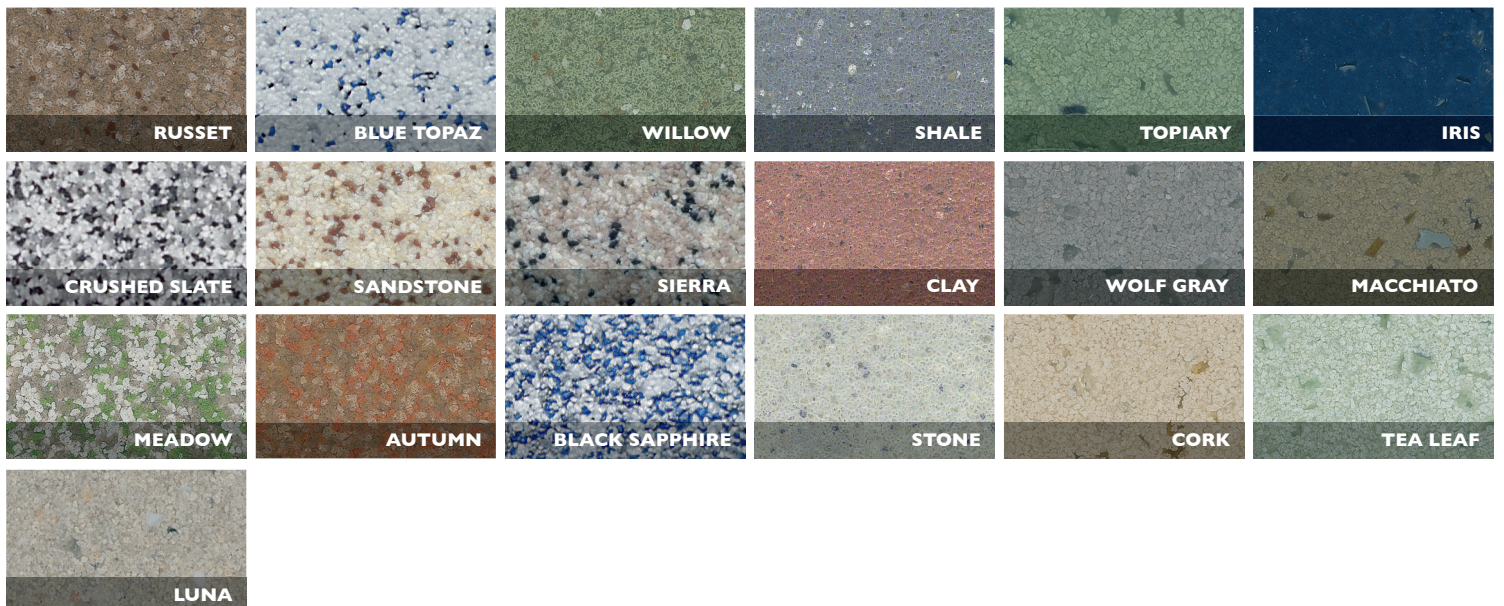

STONRES

Tradition, partnered with innovation, in a floor that has been proclaimed to be in its own genre. Stonres is a seamless, resilient floor that combines distinctive design elements with performance and function, using intricate patterns and a vast progressive colour palette in a smooth, stain resistant, ergonomic and noise-reducing system. And like other Stonhard floors, Stonres meets the challenges of industrial surroundings, yet is created with public spaces in mind – healthcare, education, retail environments, as well as museums, concourses, lobbies and arenas.

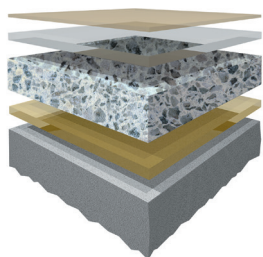

Stonseal Sealer
Stonres Groutcoat
Stonres RTZ Mortar
Stonhard Primer
Substrate

RTZ

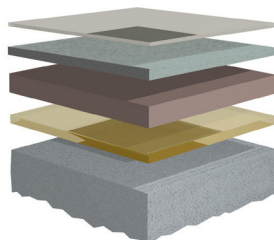

Stonseal Sealer
Stonres Undercoat
Stonres Mortar
Stonhard Primer
Substrate

STR



STONRES® RTZ

Ergonomic, resilient, noise-reducing floor that gives planners designer-worthy options for high profile public spaces. A bountiful colour palette can be incorporated into traditional patterns or customize free-form designs for healthcare, education and public spaces. Highly recommended for operating theatres; supports infection control programs.

STONRES® STR

Ergonomic, resilient, noise-reducing urethane floor in a solid, matte finish. It is also ideal for open space projects, such as corridors and labs in hospitals and schools.

RTZ

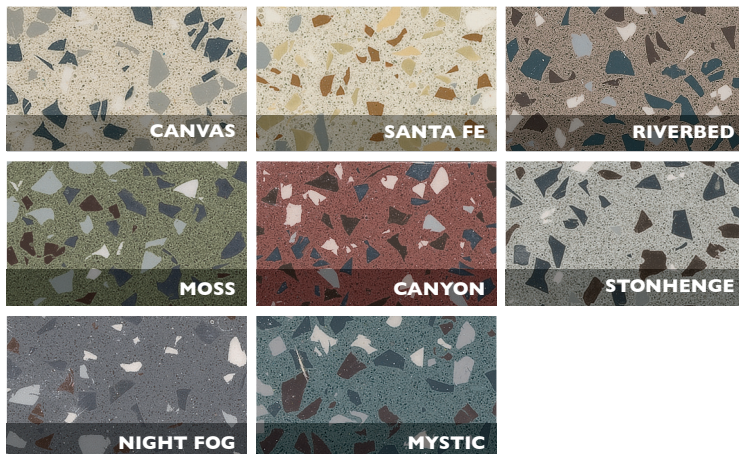

STR



STONTEC

A dense, stain resistant flake system, with an extensive range of finishes and colour options. Stontec floors minimize downtime for renovations, and save critical path time on new construction projects, while offering exceptional design options.

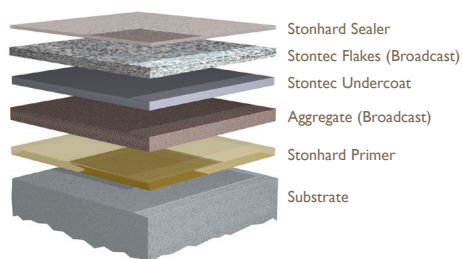

ERF|UTF|Xpress

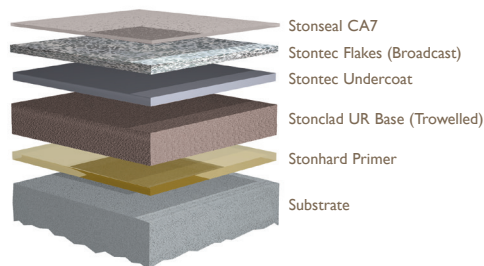

TRF

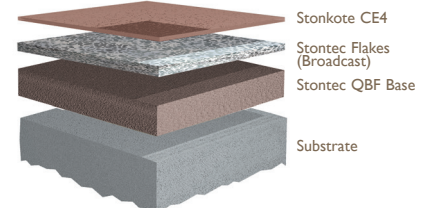

QBF



STONTEC® ERF

Epoxy system designed for use over smooth concrete. Found in healthcare, education environments, laboratories, process areas, retail, sports and entertainment venues.

STONTEC® TRF

Mortar-based urethane system designed for maximum durability and impact resistance. Created for biotech and pharmaceutical industries; recommended to meet critical path projects.

STONTEC® QBF

Liquid-based urethane system designed for durability and impact resistance when a quick installation is necessary; two day install.

STONTEC® UTF

High solids, urethane-based system with a decorative, high gloss finish and superior chemical and wear resistance capabilities. Found in healthcare, education environments, laboratories, process areas, retail, sports and entertainment venues.

STONTEC® Xpress

Methyl methacrylate resin-based system, distinguished by its rapid installation time. Chemical, stain and wear resistant floor available in a low gloss finish. Found in healthcare, education environments, laboratories, process areas, retail, sports and entertainment venues.



Stontec floors are available in both small and large flakes to provide further design options. Large flake shown above. Ask us about our other colour and style options.

STONLUX

Long-lasting, super clean, lustrous floor protection. An ultra-smooth, chemical and impact resistant formulation for areas requiring static control and a low friction surface. This system is a top choice for clean room environments. Stonlux offers a sleek and clean look.

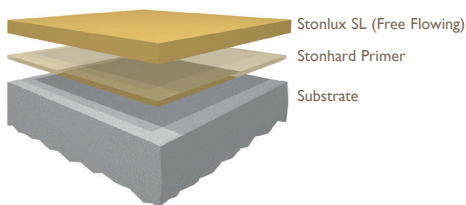
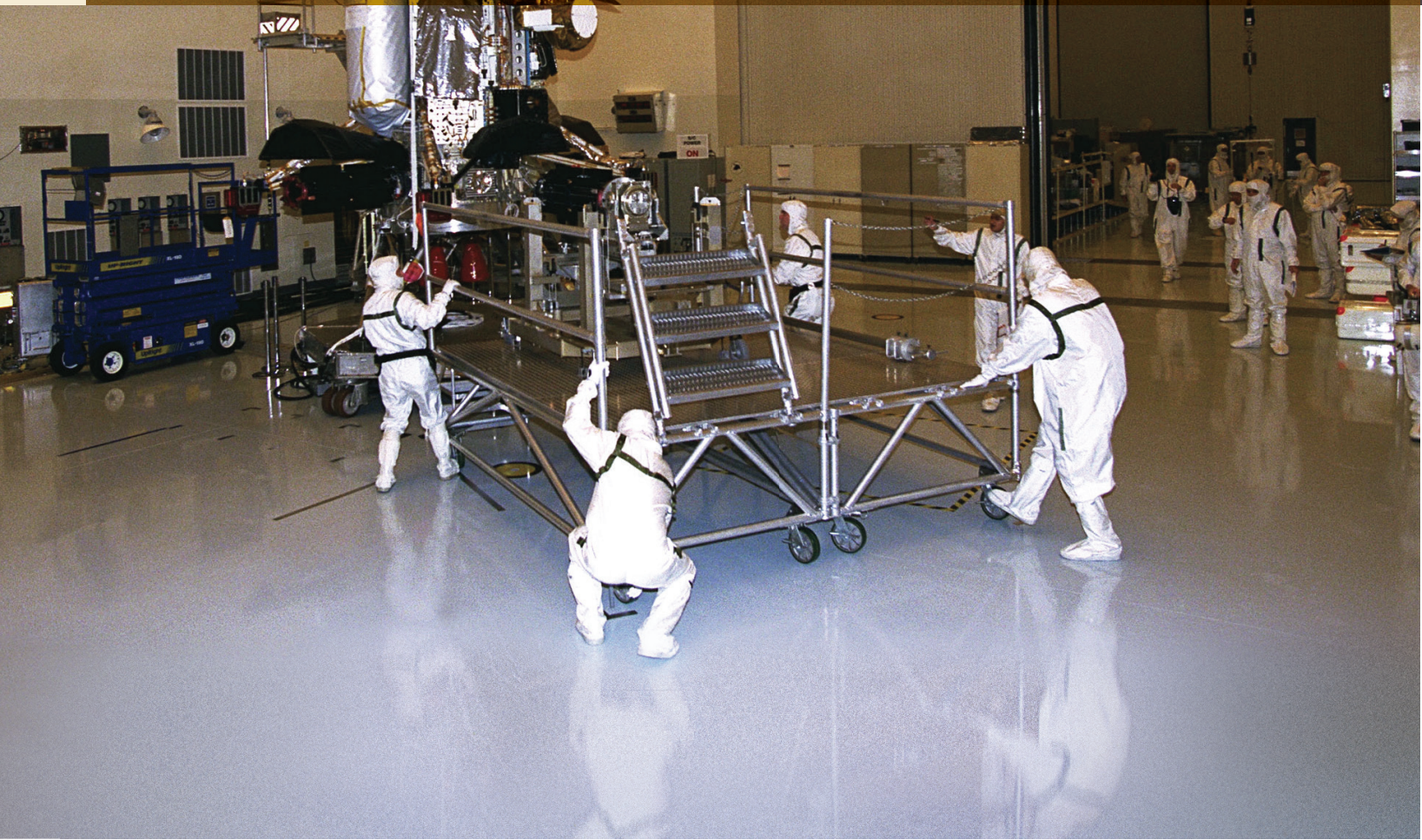

SL

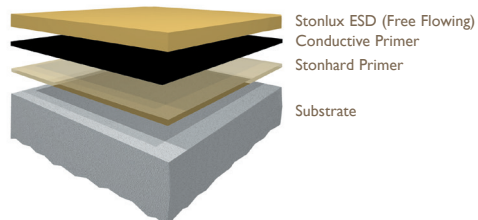

ESD

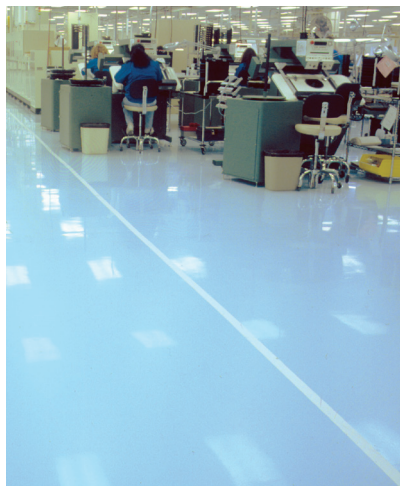

STONLUX® SL

Self-levelling epoxy formulation where a low friction surface is required. Available in 2mm and 3mm thicknesses for varying degrees of traffic and durability. Use in assembly areas, R&D facilities, light manufacturing and clean room environments.

STONLUX® ESD

Self-levelling epoxy formulation where static control is demanded. Available in 2mm and 3mm thicknesses, this formulation is also available in static dissipative and conductive formulations to meet electrical specifications. Use in electronics manufacturing and assembly areas, computer/control/clean room environments, as well as areas where munitions are present.

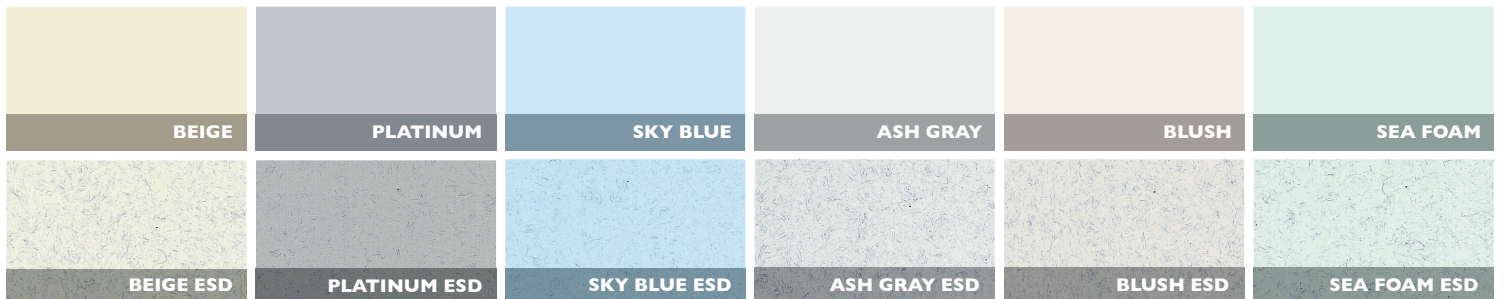

STONGARD

Slip, abrasion and crack resistant systems fill the niche for parking garages and mechanical equipment rooms, by providing premiere traffic bearing membranes and superior positive side waterproofing moisture protection. Stongard can improve safety in garages by reducing slips and falls. Four superbly designed systems offer reliable defence with many options to meet specific demands.

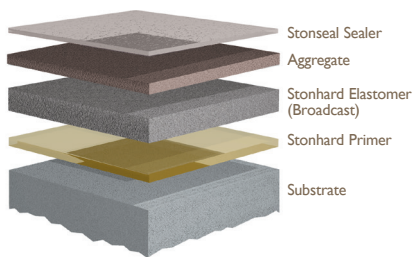

T M

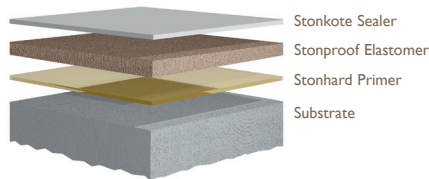

M R

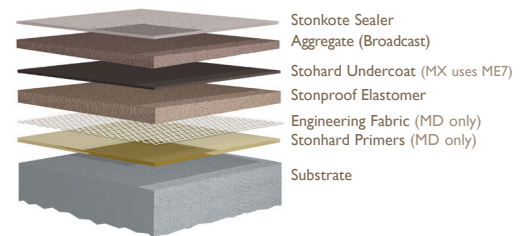

M D | M X



STONGARD™ TM

Durable, elastomeric traffic bearing membrane designed for heavy pedestrian or vehicular traffic areas in parking structures, ramps, stadium concourses, helipads and pedestrian bridges. Can stand up to harsh elements, such as sun, salts and corrosive fluids.

STONGARD™ MR

An elastomer-based flooring system created for positive side waterproofing applications. It is designed to protect areas below mechanical rooms, pump and mezzanine floors from water damage.

STONGARD™ MD

An elastomer-based, slip resistant, decorative, positive side waterproofing system created for mechanical rooms, pump mezzanines or any indoor space requiring moisture protection with a focus on design.

STONGARD™ MX

An elastomer-based, slip resistant, waterproofing system reinforced with fibreglass where additional performance is needed. Designed for mechanical rooms, pump mezzanines or any indoor space requiring waterproofing.



Silver Gray available in Stongard MR and Stongard MX only.

ENGINEERING DETAILS

Stonhard is recognized globally for solving flooring problems. We are the world's largest turnkey, seamless flooring contractor committed to comprehensive management of each project from construction documentation to the final details. No hidden costs, no sudden change orders and scrupulous attention to details.

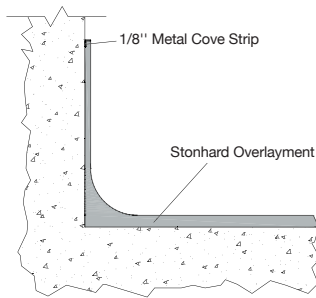

COVE BASE DETAIL WITH COVE STRIP

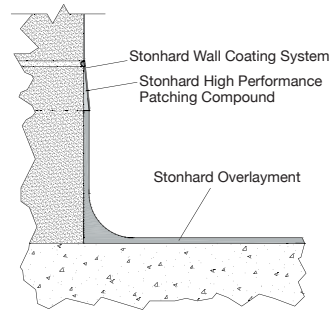

GMP COVE BASE DETAIL WITH CMU BLOCK

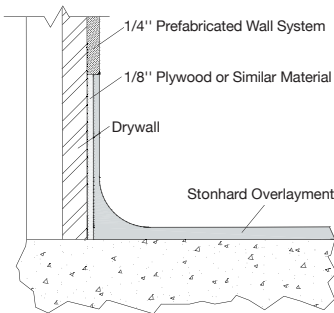

COVE BASE DETAIL WITH PREFABRICATED WALL SYSTEM

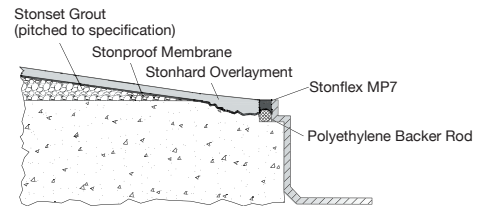

DRAIN ISOLATION DETAIL
Pre-fabricated Trench Drain with membrane

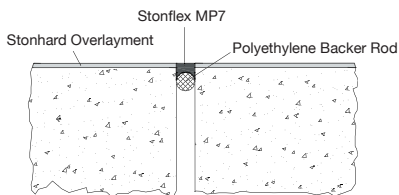

JOINT EXPANSION/ISOLATION JOINT DETAIL

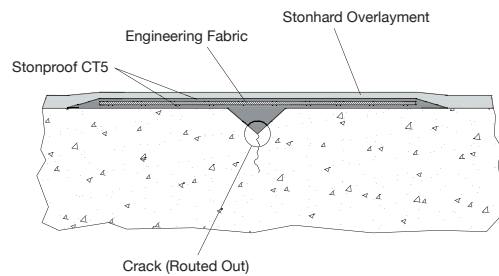

CRACK TREATMENT
Stonproof CT5 with fiberglass reinforcement

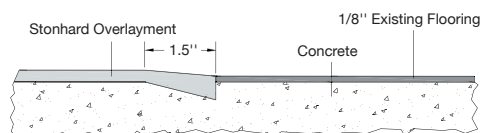

TRANSITION TO EXISTING FLOOR

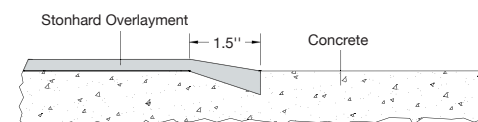

STANDARD CHASE DETAIL

STONHARD BRINGS YOU GREAT PRODUCTS FOR THE GREAT OUTDOORS

Stonhard manufactures and installs long lasting, versatile floor solutions for indoor AND outdoor applications too! Resorts, restaurants, pool decks, rooftop bars, parking garages, stadium ramps, walkways and pathways, entrances and drop off areas and helipads for hospitality, healthcare, education markets and more.

STONPATH

Durable, slip resistant, tactile, quick to install brick and stone-like, fibre reinforced polymer system transforms walkways, patios and entrances into skid resistant surfaces with multiple design options and colours. Detailed custom logos. Formulated for university, healthcare and hospitality environments.



STONDECK

Resilient, slip resistant surface, stands up to severe weather, salt and chlorinated water and extreme changes from hot to cold temperatures. Easy to clean, seamless or tiled surface, teak look with free form designs in a resort colour collection. Created for the hospitality environment.



MORE OPTIONS & SOLUTIONS

Extensive Range of Complementary Products, Corrosion Resistant Linings, Easy to Clean Wall Systems, Static Control Protection, Anti-Microbial Formulations & Cleaning Recommendations.



COMPLEMENTARY PRODUCTS – Grouts, Coatings, Cove Bases, Elastomers for pitching, patching, protecting.

COATINGS & LININGS – Six different chemistries for incomparable long-term protection in the most corrosive environments. The Stonchem product line is a leader in protection for secondary containment, processing areas, chemical storage and battery rooms.

STATIC CONTROL FLOORS – Available throughout Stonhard's product lines, including Stonkote ESD, a self-levelling conductive system. At 20-25 mils thick, this smooth surface is easy to clean and controls static electricity in electronics, packaging, assembly and test environments.

STONHARD

ANTI-MICROBIAL SOLUTIONS – Stonplus AM9 can be added to formulations to help block microorganisms; the growth of bacteria, fungi and moulds. Stonplus AM9 is sought by food & beverage and healthcare companies as part of their stringent efforts to control harmful bacteria.

MMA/FAST TRACK RESULTS – Methyl Methacrylate formulations and technology, incorporated throughout our product families to expedite installation time. Ideal for fast-track projects and operations with limited to no shut-down time.

WALL SYSTEMS – Smooth and seamless walls protect concrete, block, steel or drywall from splashes, spills, fumes and abrasion. Flake systems available too.

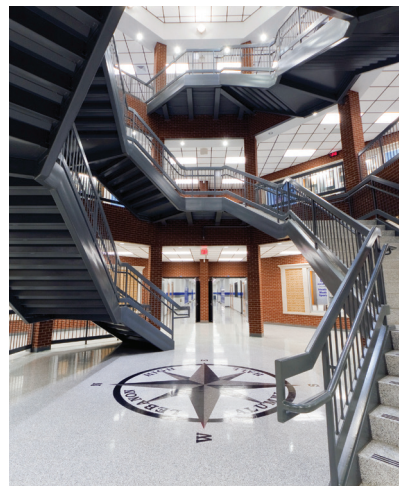

OUR OTHER BRANDS

Stonhard is part of The Stonhard Group, offering floors for every environment. Find out about our other brands producing outstanding designs and sustainable surfaces for commercial spaces.



Distinct, seamless designs for high profile commercial projects; hotels, restaurants, car showrooms & retail environments. liquidelements.com



Floor Score Certified, flexible terrazzo tile for schools and universities, airports and corporate spaces. fritztile.com



Cork, recycled rubber and cork/rubber floors for commercial spaces; universities, stadiums, airports & libraries. expanko.com

HOW TO CLEAN YOUR FLOOR

STONKLEEN

Stonhard's cleaning and maintenance division recommends a wide range of cleaning products, including disinfectants, degreasers, green products, and specialty cleaners to remove stubborn tyre marks and chemical stains, including Betadyne. The Stonkleen teams work in conjunction with your Stonhard Territory Manager to provide "how to clean your floor" instruction, along with personalized product recommendations. Ask your Territory Manager about best products and practices for cleaning your floors. stonkleen.com **866.505.7866**

STONHARD is a global leader in manufacturing and installing seamless floor, wall and lining systems with sales operations in more than 65 countries. Stonhard has a direct sales force in North America, Europe, South Africa and parts of the Middle East, and works through a dedicated network of Stonhard affiliates throughout the rest of the world.

STONHARD®

Stonhard Worldwide

Maple Shade, NJ, USA
800.257.7953

Whitby, Ontario, Canada
(905) 430.3333

Mexico City, Mexico
(52) 55.9140.4500

Buenos Aires, Argentina
(54.3327) 44.2222

Nivelles, Belgium
(32) 67.493.710

Dubai, U.A.E.
(971) 4.3470460

Johannesburg, South Africa
(27) 11.254.5500

Shanghai, China
(86) 21.61838698

Melbourne, Australia
(03) 9587.7433

U.S. Sales and Distribution

Maple Shade, NJ
Atlanta, GA
Dallas, TX
Chicago, IL
San Francisco, CA

Stonhard believes the information contained here to be true and accurate. Stonhard makes no warranty, expressed or implied based on this literature and assumes no responsibility for consequential or incidental damages in the use of these products and systems described, including any warranty of merchantability or fitness. Information contained here is for evaluation only. ©2015.

stonhard.com

